

FILE: E:\2017 PLANS\PREMIER POOLS & SPAS\ARGUELLES.DWG
PLOT DATE: 7/18/2017

SPA SPECS:
SIZE: 6'-6" DIA.
DEPTH: 5'
PERIMETER: 20
AREA: 33
VOLUME: 555
TURNOVER: 7 MIN.
SPILLWAY: 24" NOTCHED
THERAPY JETS: 4
LIGHT: 12 9W L.E.D.
ENTRY STEP: NO
RAISED: 12" PEDESTAL

POOL SPECS:
SIZE: 12' X 25'-6"
DEPTH: 5' TO 5'
PERIMETER: 70
AREA: 260
VOLUME:
TURNOVER: 6 HR. MIN. (25 GPM @ LOW SPEED)
COPING: SQUARE EDGE TRAVERTINE
TILE: 6"
SKIMMER: 1
RETURNS: 3
VAC LINE: YES
LIGHT: 1-30W JANDY NITCHELESS L.E.D.
SKIMMOUT: 18" @ SPA
FINISH: STONECAPES
RAILINGS: NO
PATIO: TRAVERTINE
ENCLOSURE: EXISTING FENCE
FOOTERS: NO
DECK-O-DRAIN: IF NEEDED
SUNSHELF/1ST STEP. PATIO STEP DOWNS
STUCCO REAR EXPOSED POOL WALL

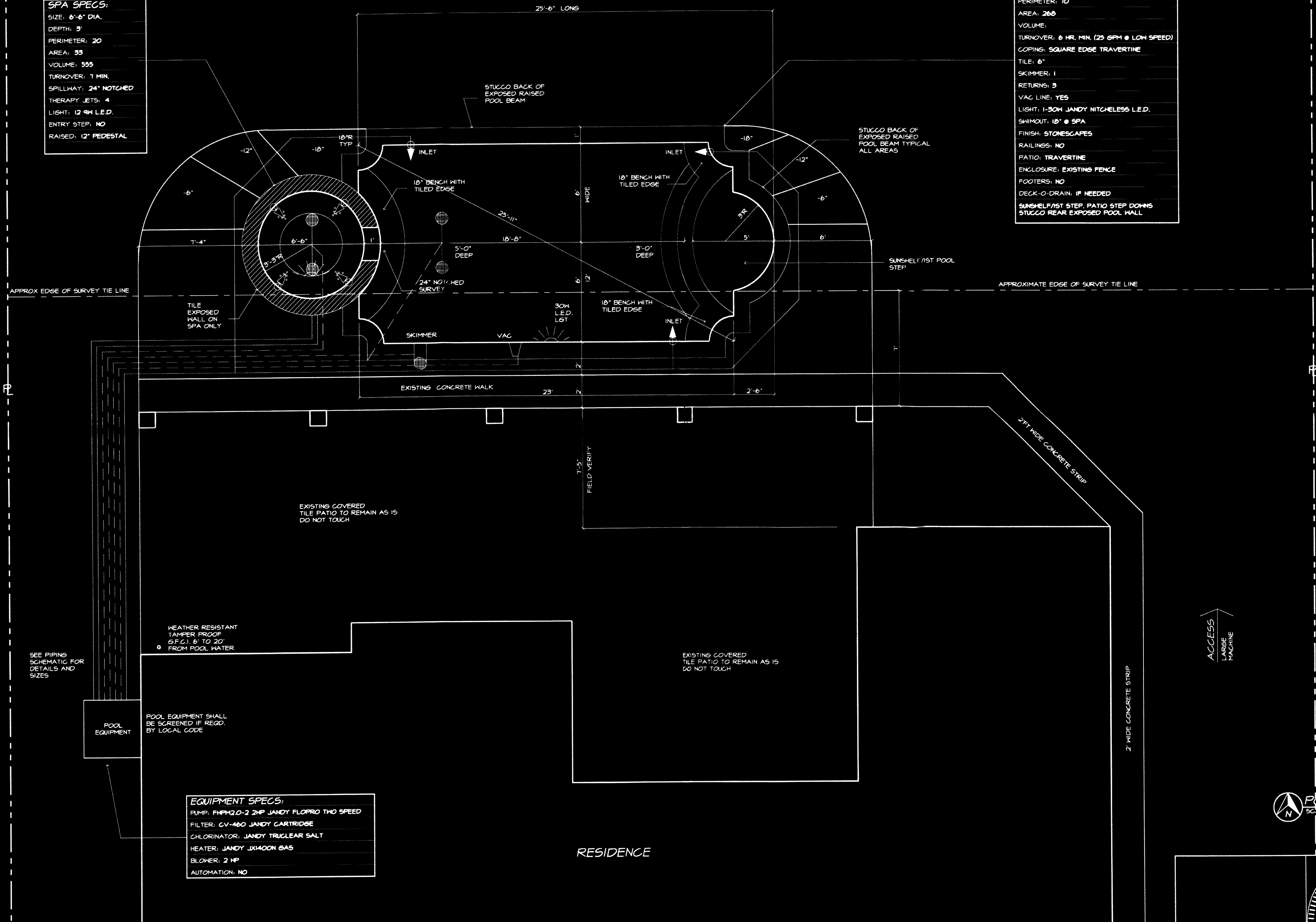

EQUIPMENT SPECS:
PUMP: FHP120-2 2HP JANDY FLOPRO TWO SPEED
FILTER: CV-460 JANDY CARTRIDGE
CHLORINATOR: JANDY TRICLEAR SALT
HEATER: JANDY JX1400N GAS
BLOWER: 2 HP
AUTOMATION: NO

POOL PLAN
SCALE: 1/4" = 1'-0"



806 S MILITARY TRAIL
DEERFIELD BEACH, FL
33442
PHONE: 954-637-0707

JOB SITE SPECIFICATIONS
LOT: 46 BLOCK: 2
SUBDIVISION: MIAMI LAKES SECTION 1
PLAT BOOK: 15 PAGE: 35
COUNTY: MIAMI-DADE

SWIMMING POOL PLAN FOR:
RUBEN ARGUELLES
6421 LAKE PATRICIA ROAD
MIAMI LAKES, FLORIDA 33014

DRAWING ITEMS
DATE: 6-18-17
ORDER #: 244
DRAWN BY: N.A.S.
PLAN # 17099-20
SHEET: 1 OF 2

REVISIONS:

IF SIGNED DIGITALLY ABOVE, PRINTED COPIES OF THIS DOCUMENT ARE
NOT CONSIDERED SIGNED AND SEALED AND THE SIGNATURE MUST BE
VERIFIED ON ANY ELECTRONIC COPIES

7/18/2017

WAYNE MARKHAM BENNETT
P.E. # 51216 / (RS) 818-3825
265 S. FEDERAL HWY. # 108
DEERFIELD BEACH, FL 33441
WAYNE@WMB-PE.COM

